

SOUNETE

EQUIPAMENTOS PARA PESCA INDUSTRIAL
TRAWL FISHING HARDWARE AND GEAR

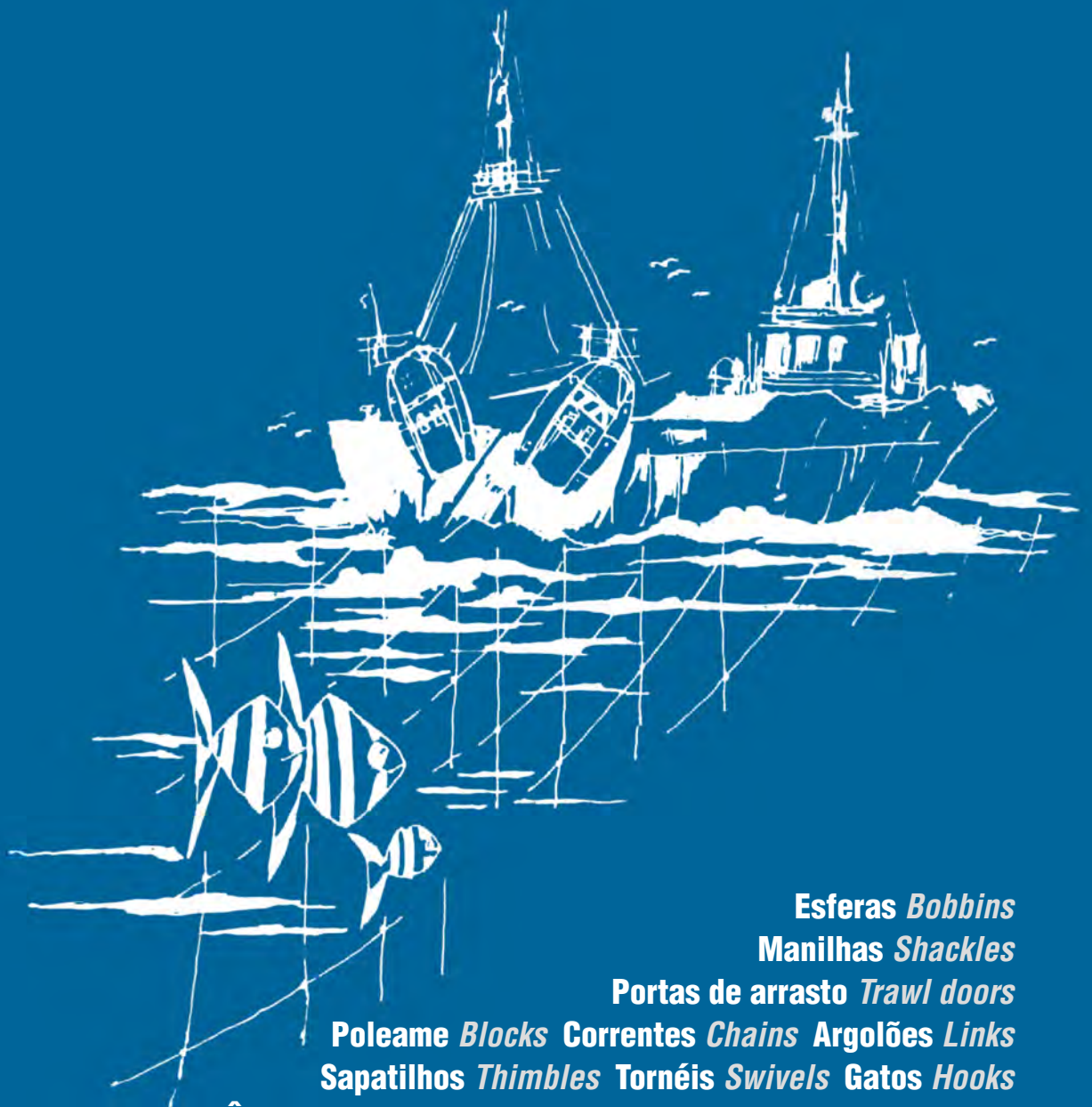

Esferas *Bobbins*
Manilhas *Shackles*
Portas de arrasto *Trawl doors*
Poleame *Blocks* Correntes *Chains* Argolões *Links*
Sapatilhos *Thimbles* Tornéis *Swivels* Gatos *Hooks*
Âncoras *Anchoring* Aprestos de aço alloy *Alloy steel gear*
Equipamentos para aquicultura *Aquaculture equipment*
Equipamentos especiais *Special equipments*

Apreostos metálicos diversos
Assorted metal gear

Pg.67-75

SOUNETE
Internacional, S.A.

Rua da Seara 588
Oliveira do Douro
V.N.Gaia
Portugal

NIPC
513 830 375

TEL / FAX
+351 227 860 930
+351 227 860 935

POST
Apartado 290
4431 -904 V.N.Gaia
Portugal

EMAIL
sounete@sounete.pt

URL
www.sounete.pt

AM - ARGOLÃO DA MALHETA
KELLY EYE

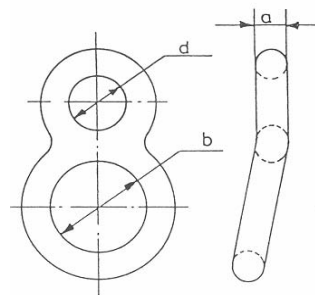

REFERENCE REFERENCIA	DIMENSIONS (MM) DIMENSIONES (MM)			S.W.L. Kgs.	WEIGHT PESO Kgs
	A	B	C		
AM20	20	70	25	3.000	1,150
AM22	22	80	32	3.750	1,500
AM25	25	80	32	4.800	2,000
AM28	28	85	40	6.000	2,960
AM32	32	100	45	7.500	4,100
AM40	40	100	45	12.000	7,115

OM - OITO DA MALHETA
STOPPER

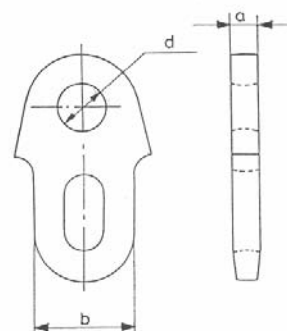

REFERENCE REFERENCIA	DIMENSIONS (MM) DIMENSIONES (MM)			S.W.L. Kgs.	WEIGHT PESO Kgs
	A	B	C		
OM20	20	67	28	3.000	1,265
OM22	22	77	35	3.750	2,380
OM25	25	77	35	4.800	2,500
OM28	28	82	40	6.000	2,755
OM32	32	97	45	7.500	3,775
OM40	40	97	45	12.000	4,260

TRB - TRIANGULO DO CALÃO COM BARRA
TRIANGULAR ARM

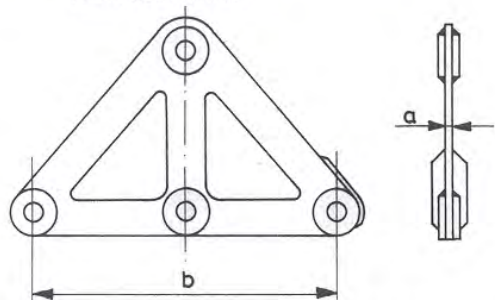

REFERENCIA REFERENCE	DIMENSÕES (mm) DIMENSIONS (MM)		PESO WEIGHT KGS
	A	B	
TRB12	12	540	11,500
TRB16	16	540	14,000

TRE - TRIANGULO DO CALÃO MODELO ESCALENO
SCALENE ARM

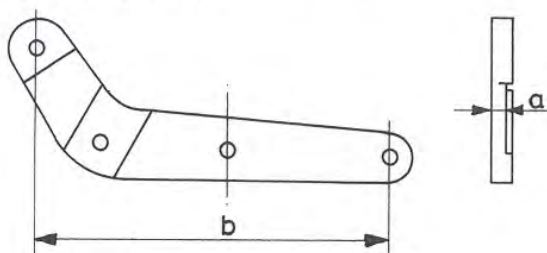

REFERENCIA REFERENCE	DIMENSÕES (mm) DIMENSIONS (MM)		PESO WEIGHT KGS
	A	B	
TRE25	25	640	17,500

TRD - TRIANGULO DO CALÃO TIPO DELTA
DELTA PLATE

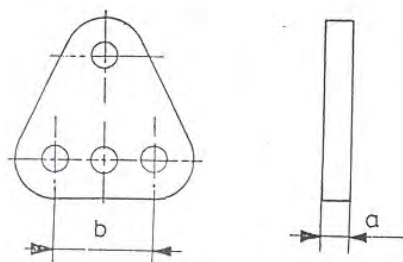

REFERENCIA REFERENCE	DIMENSÕES (mm) DIMENSIONS (MM)		PESO WEIGHT KGS
	A	B	
TRD12120	12	120	
TRD30120	30	120	
TRD12150	12	150	
TRD30150	30	150	
TRD30220	30	220	

FA - FUNIL PARA O ARRASSAL
FUNNEL FOR PROTECTING SHACKLE

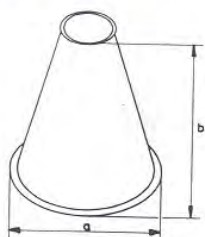

REFERENCIA REFERENCE	DIMENSÕES (mm) DIMENSIONS (MM)		PESO WEIGHT KGS
	A	B	
FA225	225	160	2,000

PAT - PATOLA PARA DESCARGA
BARREL HOOKS

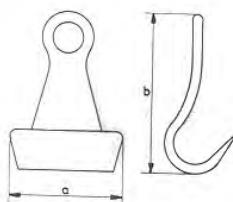

REFERENCIA REFERENCE	DIMENSÕES (mm) DIMENSIONS (MM)		PESO WEIGHT KGS
	A	B	
PAT060	60	119	0,900
PAT100	100	117	1,000

ETOO - ESTICADOR DE TUBO COM OLHAL-OLHAL
CLOSED BODY RIGGING SCREW EYE-EYE

ETOF - ESTICADOR DE TUBO COM OLHAL-FORQUETA
CLOSED BODY RIGGING SCREW EYE-JAW

ETFF - ESTICADOR DE TUBO COM FORQUETA-FORQUETA
CLOSED BODY RIGGING SCREW JAW-JAW

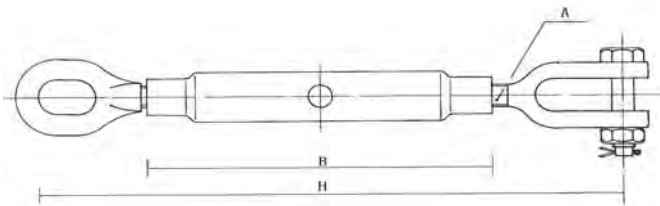

ETOO

ETOF

ETFF

REFERÊNCIA REFERENCE			S. W. L. KGS.	DIMENSÕES (MM) DIMENSIONS (MM)									PESO (KGS.) WEIGHT (KGS.)		
ETOO	ETOF	ETFF		A			FECHADO / CLOSED			H ABERTO / OPEN			ETOO	ETOF	ETFF
				INCHES	MM	B	ETOO	ETOF	ETFF	ETOO	ETOF	ETFF			
ETOO06	ETOF06	ETFF06	100	1/4"	6	90	130	141	152	210	224	238	0,100	0,120	0,140
ETOO08	ETOF08	ETFF08	160	5/16"	8	105	160	170	180	215	265	295	0,125	0,160	0,195
ETOO10	ETOF10	ETFF10	250	3/8"	10	120	178	193	223	280	305	330	0,190	0,230	0,270
ETOO11	ETOF11	ETFF11	300	7/16"	11	140	210	230	250	330	350	370	0,290	0,340	0,410
ETOO13	ETOF13	ETFF13	400	1/2"	13	170	278	290	302	410	430	450	0,545	0,600	0,675
ETOO14	ETOF14	ETFF14	500	9/16"	14	190	310	320	330	450	472	494	0,680	0,780	0,900
ETOO16	ETOF16	ETFF16	630	5/8"	16	200	327	340	353	500	520	540	1,045	1,100	1,155
ETOO20	ETOF20	ETFF20	1.000	3/4"	20	220	355	375	395	550	570	590	1,430	1,610	1,790
ETOO22	ETOF22	ETFF22	1.500	7/8"	22	240	400	420	440	620	640	660	2,215	2,360	2,505
ETOO25	ETOF25	ETFF25	2.000	1"	25	260	420	455	490	660	695	730	3,400	3,700	4,000
ETOO28	ETOF28	ETFF28	2.500	1.1/8"	28	300	520	530	540	760	770	780	4,400	5,000	5,600
ETOO32	ETOF32	ETFF32	3.150	1.1/4"	32	330	550	570	590	810	830	850	5,300	6,500	7,700
ETOO38	ETOF38	ETFF38	5.000	1.1/2"	38	360	580	640	700	880	950	1.020	11,200	12,000	12,800
ETOO45	ETOF45	ETFF45	6.300	1.3/4"	45	410	680	730	780	1.010	1.060	1.130	13,200	15,500	17,800
ETOO50	ETOF50	ETFF50	8.000	2"	50	460	720	830	940	1.120	1.230	1.340	18,800	22,000	25,200

C C - CERRA CABOS GALVANIZADOS
GALVANISED WIRE ROPE CLIPS

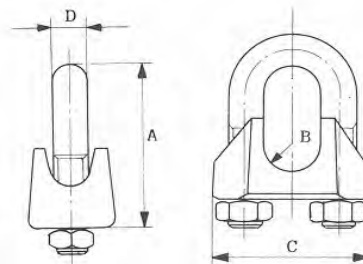

C C

REFERÊNCIA REFERENCE	Ø CABO Ø ROPE		DIMENSÕES (MM) DIMENSIONS (MM)				PESO WEIGHT KGS.
	POLG. INCHES	MM	A	B	C	D	
CC03	1/8"	3	20	1,5	21	4	0,013
CC05	3/16"	5	24	2,5	23	5	0,019
CC06	1/4"	6,5	28	3,5	26	5	0,035
CC08	5/16"	8	34	4	30	6	0,041
CC10	3/8"	10	42	5	34	8	0,048
CC11	7/16"	11	44	5,5	36	8	0,079
CC13	1/2"	13	55	6,5	42	10	0,130
CC14	9/16"	14	57	7	44	10	0,135
CC16	5/8"	16	63	8	50	12	0,210
CC20	3/4"	19	75	9,5	54	12	0,275
CC22	7/8"	22	85	11	61	14	0,315
CC25	1"	26	95	13	65	14	0,360
CC28	1.1/8"	30	110	15	74	16	0,660
CC32	1.1/4"	34	120	17	80	16	0,850
CC40	1.1/2"	40	140	20	88	16	1,040

E T A O G - ESTICADORES ABERTOS COM OLHAL E GATO
OPEN RIGGING SCREWS EYE-HOOK

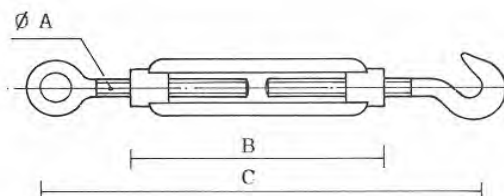

E T A O G

REFERÊNCIA REFERENCE	S. W. L. KGS.	POLG. INCHES	DIMENSÕES (MM) DIMENSIONS (MM)				PESO WEIGHT KGS.
			A	B	C		
					FECHADO CLOSED	ABERTO OPEN	
ETAOG05	75	3/16"	5	62	110	155	0,050
ETAOG06	100	1/4"	6	110	160	230	0,105
ETAOG08	160	5/16"	8	110	165	230	0,185
ETAOG10	250	3/8"	10	125	210	285	0,300
ETAOG12	400	1/2"	12	130	210	290	0,410
ETAOG14	500	9/16"	14	165	250	370	0,565
ETAOG16	630	5/8"	16	170	280	380	0,980
ETAOG20	1.000	3/4"	20	215	330	475	1,550
ETAOG22	1.500	7/8"	22	240	370	525	2,150
ETAOG25	2.000	1"	25	250	385	530	2,700

TAMBÉM PODEMOS FORNECER COM 2 OLHAIS OU 2 GATOS.
PARA ESTES CASOS A REF. SERÁ RESPECTIVAMENTE ETAOO E ETAGG, ACRESCIDA DOS MESMOS NÚMEROS.
AVAILABLE WITH EYE-EYE AND HOOK-HOOK.
THE REFERENCE IS ETOO OR ETGG FOLLOWED BY THE SAME NUMBERS

ESPICHAS - SPIKES

D

ECB - ESPICHA CABO DE BOLA
STEEL SPICK ROUNDED STEEL HANDLE

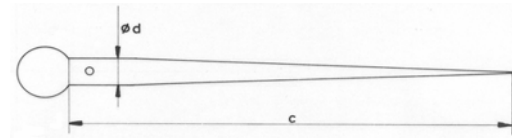

REFERENCIA REFERENCE	DIMENSÕES (mm) DIMENSIONS (mm)		PESO WEIGHT Kgs
	d	c	
ECB20250	20	250	0,625
ECB22300	22	300	0,920
ECB25350	25	350	1,310
ECB28450	28	450	2,110
ECB28500	28	500	2,310
ECB28600	28	600	2,675

ECPM - CAVEIRÃO DE MADEIRA COM PONTA METÁLICA
WOODEN FID WITH METALLIC POINT

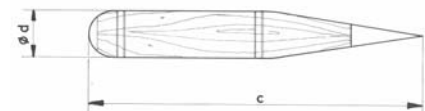

REFERENCIA REFERENCE	DIMENSÕES (mm) DIMENSIONS (mm)		PESO WEIGHT Kgs
	d	c	
ECPM35240	35	240	0,280
ECPM40280	40	280	0,310
ECPM50320	50	320	0,480

ECAI - CAVEIRÃO DE MEIA CANA EM AÇO INOX
STAINLESS STEEL SPLICING SPICK

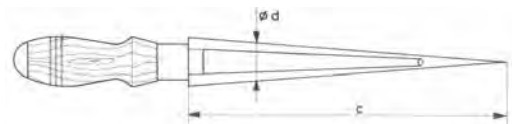

REFERENCIA REFERENCE	DIMENSÕES (mm) DIMENSIONS (mm)		PESO WEIGHT Kgs
	d	c	
ECAI40250	40	250	0,350
ECAI40300	40	300	0,410
ECAI40350	40	350	0,480



SOUNETE - FÁBRICA DE APRESTOS METÁLICOS, LDA.

RUA DA SEARA, 588 - OLIVEIRA DO DOURO
APARTADO, 290 - 4431-904 VILA NOVA DE GAIA - PORTUGAL
TELEFONES (351) 227860930 - FAX (351) 227860935 - E-mail comercial@sounete.pt - WEB www.sounete.pt

BV - BICHEIRO DE VARA
GAFF FOR WOODEN STICK



REFERENCIA REFERENCE	DIAMETRO (mm) DIAMETER (mm)	PESO WEIGHT Kgs
BV06	6	0,045
BV08	8	0,120
BV10	10	0,200
BV12	12	0,315
BV16	16	0,600
BV20	20	0,775

AC - ARCO DO CAPINETE
DIP NET BOWS

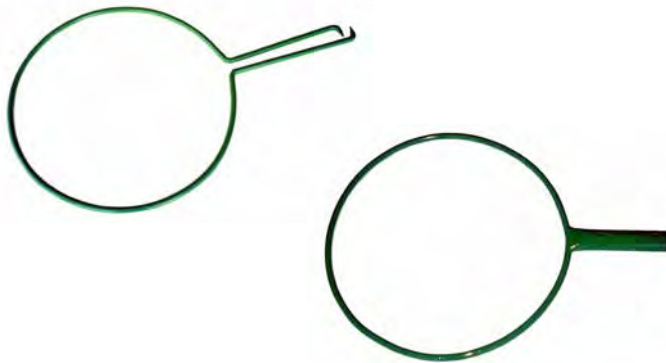

REFERENCIA REFERENCE	DIMENSÕES (mm) DIMENSIONS (mm)	PESO WEIGHT Kgs
	ABERTOS/OPENED	
AC10A	10 x 400	0,800
AC12A	12 x 500	1,600
AC16A	16 x 500	2,400
	FECHADOS/CLOSED	
AC10CT	10 x 400	0,900
AC10ST	10 x 400	0,750

CF - CORTA-FRIO
WIRE ROPES CUTTERS

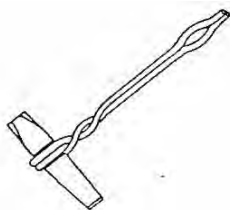

GFE2

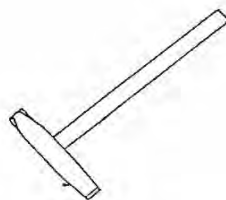

GFN2

REFERENCIA REFERENCE	DIMENSÕES (mm) DIMENSIONS (mm)	PESO WEIGHT Kgs
GFE2	MÉDIO / MEDIUM	6,000
GFN2	MÉDIO / MEDIUM	4,000

FELC - TESOURA DE CORTAR CABOS DE AÇO
WIRE ROPES HAND CUTTER



REFERENCIA REFERENCE	PARA CABO AÇO PER WIRE ROPE Ø 16 MM	PESO WEIGHT Kgs
FELC16	TESOURA	
TCCL16	LÂMINA	
TCCH16	HASTE	
TCCA16	CONJUNTO ACESSÓRIOS	

MA1M - MALHO EM AÇO COM CABO DE MADEIRA
STRAIGHT PEIN SLEDGE WITH WOODEN HANDLE



MA2M - MARRETA QUADRADA EM AÇO COM CABO DE MADEIRA
SQUARE HEAD SLEDGE WITH WOODEN HANDLE



REFERÊNCIA REFERENCE	PESO WEIGHT KGS.
MA1M2	2.000
MA1M3	3.000
MA1M4	4.000
MA1M5	5.000
MA2M1	1.000
MA2M2	2.000
MA2M3	3.000
MA2M5	5.000
MA2M8	8.000

ALS - ALAVANCA EM AÇO - SIMPLES
STEEL CROWBAR - SIMPLE

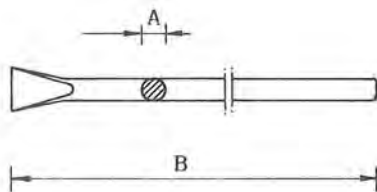

ALS - ALAVANCA EM AÇO COM ASA
STEEL CROWBAR - WITH HANDLE

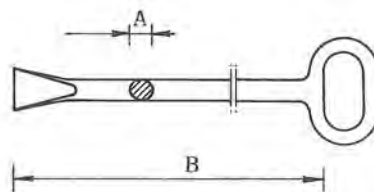

ALP - ALAVANCA EM AÇO - PÉ DE CABRA
CURVED CLAW WRECKING BAR

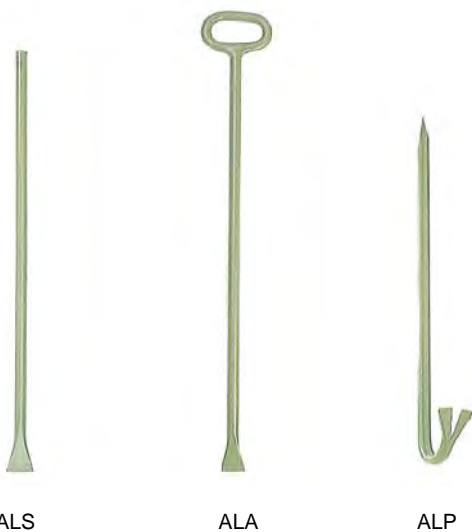
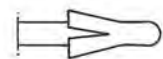
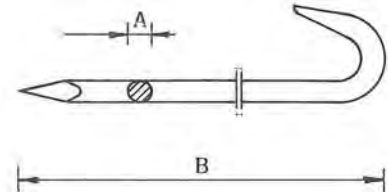

ALS

ALA

ALP

REFERÊNCIA REFERENCE	DIMENSÕES (MM) DIMENSIONS (MM)		PESO WEIGHT KGS.
	A	B	
ALP250400	25	400	1,850
ALP280800	28	800	4,230
ALP321200	32	1.200	8,250
ALA281000	28	1.000	5,840
ALA321200	32	1.200	8,520
ALS281000	28	1.000	4,700
ALS321200	32	1.200	7,630

CHO - CHUMBO TIPO PIPO PARA REDES DE PESCA
SINKER FOR FISHING NETS



REFÊRENCIA REFERENCE	DIMENSÕES DIMENSIONS		PESO WEIGHT grs
	FURO (MM) HOLE (MM)	P/CORDA (MM) FOR ROPE (MM)	
CHO030-055	5,5	5	30
CHO030-065	6,5	6	30
CHO030-075	7,5	7	30
CHO035-065	6,5	6	35
CHO050-065	6,5	6	50
CHO050-080	8,0	7	50
CHO060-085	8,5	8	60
CHO100-065	6,5	6	100
CHO100-105	10,5	10	100
CHO150-110	11,0	10	150
CHO150-125	12,5	12	150
CHO250-125	12,5	12	250
CHO250-150	15,0	14	250
CHO300-150	15,0	14	300
CHO350-150	15,0	14	350

ZIN - ANODOS DE ZINCO
ANODS



REFÊRENCIA REFERENCE	PESO WEIGHT KGS
ZIN00900	0,900
ZIN02400	2,400
ZIN03500	3,500
ZIN04400	4,400
ZIN05600	5,600

SOUNETE

EQUIPAMENTOS PARA PESCA INDUSTRIAL
TRAWL FISHING GEAR

Sounete Internacional, S.A.

Rua da Seara 588 || Apartado 290 || 4431-904 V.N.Gaia || Portugal

Telf +351 227 860 930 || Email sounete@sounete.pt || www.sounete.pt